

vtech[®]
Baby

User's Manual

My 1st Activity Lion



© 2016 VTech
Printed in China

91-003164-001-006 ©

VTech understands that a child's needs and abilities change as they grow and with that in mind we develop our toys to teach and entertain at just the right level...

vtech Baby

Toys that will stimulate their interest in different textures, sounds and colours

I am...

...responding to colours, sounds and textures

...understanding cause and effect

...learning to touch, reach, grasp, sit-up, crawl and toddle

Pre-School

Interactive toys to develop their imagination and encourage language development

I want...

...to get ready for school by starting to learn the alphabet and counting

...my learning to be as fun, easy and exciting as can be

...to show my creativity with drawing and music so my whole brain develops

Electronic Learning Computers

Cool, aspirational and inspiring computers for curriculum related learning

I need...

...challenging activities that can keep pace with my growing mind

...intelligent technology that adapts to my level of learning

...National Curriculum based content to support what I'm learning at school

Birth-36 months

3-6 years

4-10 years



To learn more about this and other VTech® products, visit www.vtech.co.uk

INTRODUCTION

Thank you for purchasing the **VTech® My 1st Activity Lion** learning toy!

The **My 1st Activity Lion** is a cuddly, soft lion with a variety of colours and textures. Press the shape buttons to learn colours, shapes, letters and more! Shake the lion to hear fun sounds.



INCLUDED IN THIS PACKAGE

- One VTech® My 1st Activity Lion learning toy
- One user's manual

WARNING: All packing materials, such as tape, plastic sheets, packaging locks and tags are not part of this toy, and should be discarded for your child's safety.

NOTE: Please keep this user's manual as it contains important information.

GETTING STARTED

BATTERY INSTALLATION

1. Make sure the unit is turned **OFF**.
2. Locate the battery cover on the electronic module inside the unit. Use a screwdriver to loosen the screw.
3. Install 2 new AAA(AM-4/LR03) batteries following the diagram inside the battery box. (The use of a new alkaline batteries is recommended for maximum performance.)
4. Replace the battery cover and tighten the screw to secure.

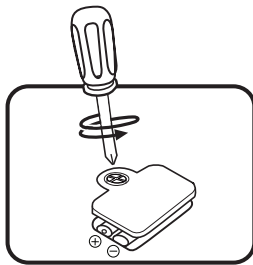

BATTERY NOTICE

- Use new alkaline batteries or fully charged NI-MH (Nickel Metal-hydride) rechargeable batteries for best performance.
- Use only batteries of the same or equivalent type as recommended.
- Do not mix different types of batteries: alkaline, standard (carbon-zinc) or rechargeable (Ni-Cd, Ni-MH), or new and used batteries.
- Do not use damaged batteries.

Included In This Package/Getting Started

- Insert batteries with the correct polarity.
- Do not short-circuit the battery terminals.
- Remove exhausted batteries from the toy.
- Remove batteries during long periods of non-use.
- Do not dispose of batteries in fire.
- Do not charge non-rechargeable batteries.
- Remove rechargeable batteries from the toy before charging (if removable).
- Rechargeable batteries are only to be charged under adult supervision.

Disposal of batteries and product



The crossed-out wheellie bin symbols on products and batteries, or on their respective packaging, indicates they must not be disposed of in domestic waste as they contain substances that can be damaging to the environment and human health.



The chemical symbols Hg, Cd or Pb, where marked, indicate that the battery contains more than the specified value of mercury (Hg), cadmium (Cd) or lead (Pb) set out in Battery Directive (2006/66/EC).

The solid bar indicates that the product was placed on the market after 13th August, 2005.

Help protect the environment by disposing of your product or batteries responsibly.



For more information, please visit:

www.recycle-more.co.uk

www.recyclenow.com

PRODUCT FEATURES

1. ON/OFF/VOLUME CONTROL SWITCH

The **ON/OFF/VOLUME CONTROL SWITCH** is located on the electronic module inside the soft lion. To turn the unit on, slide the **ON/OFF/VOLUME CONTROL SWITCH** to the **LOW VOLUME** () or the **HIGH VOLUME** () position. To turn the unit **OFF**, slide the **ON/OFF/VOLUME CONTROL SWITCH** to the **OFF** () position.

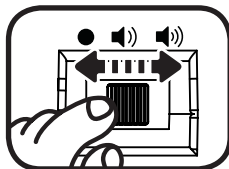

NOTE: This product is in a try-me mode in the packaging. After opening the package, turn the lion off and on again to proceed with normal play.

2. LINK

The **LINK** can be used to attach the **VTech® My 1st Activity Lion** to pushchairs, car carriers and more. To prevent strangulation, please do not use additional links to form a loop or long chain. Do not attach links across a playpen or cot.



3. REMOVABLE ELECTRONIC MODULE

To remove the **ELECTRONIC MODULE**, unfasten the hook and loop closures on the bottom of the lion and slide the electronic module out. When re-inserting the electronic module into the lion, please make sure the press buttons on the module are facing the embroidered buttons on the lion. Re-fasten the hook and loop closures.

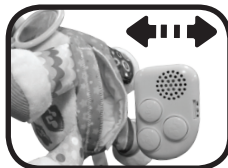

4. AUTOMATIC SHUT-OFF

To preserve battery life, the **VTech® My 1st Activity Lion** will automatically power-down after approximately 60 seconds without input. The unit can be turned on again by pressing any button. Activating the motion sensor will not turn the unit back on.

ACTIVITIES

1. Slide the **on/off/volume control switch** to turn the unit on. You will hear a playful song, a fun phrase and a short tune.

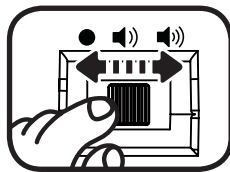



2. Press the **letter button** to learn letters, the colour and shape of the button and hear fun phrases.

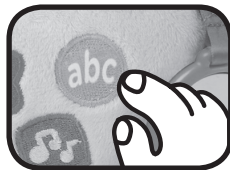

3. Press the **music button** to learn the colour and shape of the button and hear a variety of melodies. When a melody is playing, shake the lion to hear fun sounds play over the melody.



4. Press the **song button** to learn the colour and shape of the button and hear a variety of songs.



5. Shake the lion to hear fun sounds.





MELODY LIST:

1. Alphabet Song
2. Bear Went Over the Mountain
3. Good Morning Merry Sunshine
4. Listen to the Mockingbird
5. One, Two, Buckle My Shoe
6. Buffalo Gals
7. Teddy Bears' Picnic
8. Wheels On the Bus
9. Skip to My Lou
10. Head and Shoulders
11. Daring Young Man on a Flying Trapeze
12. Oh, Dear! What Can the Matter Be?
13. Sing a Song of Sixpence
14. Humpty Dumpty
15. Three Little Kittens
16. Yankee Doodle
17. Jack and Jill
18. Little Bo Peep
19. Lazy Mary Will You Get Up?
20. Old King Cole



SING-ALONG SONG LYRICS

SONG 1

I am so happy when I'm with you.
I'll tag along with you wherever you go!

SONG 2

Red, orange, yellow,
Green and blue.
I'm the colours of a rainbow.

SONG 3

A, B, C, tumble down D.
Baby's exploring shapes and playing with me!

SONG 4

Where are you hiding?
Look in my mirror.
Peek-a-boo, I see you!

CARE & MAINTENANCE

1. Keep the unit clean by wiping it with a slightly damp cloth.
2. Keep the unit out of direct sunlight and away from any direct heat source.
3. Remove the batteries when the unit will not be in use for an extended period of time.
4. Do not drop the unit on hard surfaces and do not expose the unit to moisture or water.



TROUBLESHOOTING

If for some reason the program/activity stops working or malfunctions, please follow these steps:

1. Please turn the unit **OFF**.
2. Interrupt the power supply by removing the batteries.
3. Let the unit stand for a few minutes, then replace the batteries.
4. Turn the unit **ON**. The unit should now be ready to play again.
5. If the product still does not work, replace with an entire set of new batteries.

If the problem persists, please call our Consumer Services Department on 01235 546810 (from UK) or +44 1235 546810 (outside UK) and a service representative will be happy to help you.

IMPORTANT NOTE:

Creating and developing **VTech®** products is accompanied by a responsibility that we take very seriously. We make every effort to ensure the accuracy of the information which forms the value of our products. However, errors sometimes can occur. It is important for you to know that we stand behind our products and encourage you to call our Consumer Services Department on 01235 546810 (from UK) or +44 1235 546810 (outside UK) with any problems and/or suggestions that you might have. A service representative will be happy to help you.



PRODUCT WARRANTY



Thank you for choosing this quality product from VTech. We hope it will bring many hours of entertainment, imaginative play and learning.

1. The product detailed above is covered by a one year warranty from the date of purchase, against any defects in materials or workmanship.
2. The product may be returned to the place of purchase. Alternatively the product can be returned to VTech Electronics Europe plc (see address below), with proof of purchase, without proof of purchase no replacement will be provided.
3. VTech Electronics Europe plc will examine the product and if it is found to be defective due to faulty materials or workmanship, will replace the product at their discretion.
4. If the product covered by this warranty is damaged due to misuse, modification or unauthorised repair, or because of faulty batteries, battery discharge or incorrect electrical connections, then this warranty becomes void.
5. This warranty is personal to the original purchaser and is not transferable.
6. Breakages to the LCD screen are not covered by the warranty.
7. Returns to VTech Electronics Europe plc should include a cheque or postal order for £1.50 towards the cost of return postage and packaging.
8. Products returned to VTech Electronics Europe plc, should be addressed as follows and packed carefully to avoid damage in transit (Please do not include batteries or adaptor).
Please include details of the fault together with your name and address.
9. To keep an online record of your warranty, please register your product online at www.vtech.co.uk/warranty

VTech Electronics Europe plc, c/o Tablogix Limited, 200 Milton Park, Abingdon, Oxon OX14 4TA

THIS WARRANTY IS OFFERED AS AN EXTRA BENEFIT AND DOES NOT AFFECT CONSUMERS' STATUTORY RIGHTS.

This warranty is valid for the UK and Eire only. For products purchased outside the UK and Eire, please contact your local distributor or place of purchase.

91-003164-001-006 

Join the VTech club online at www.vtech.co.uk

